

A2547 Samtec 2.54 CONNECTOR

2.54mm Pitch/Disconnectable Insulation displacement connectors

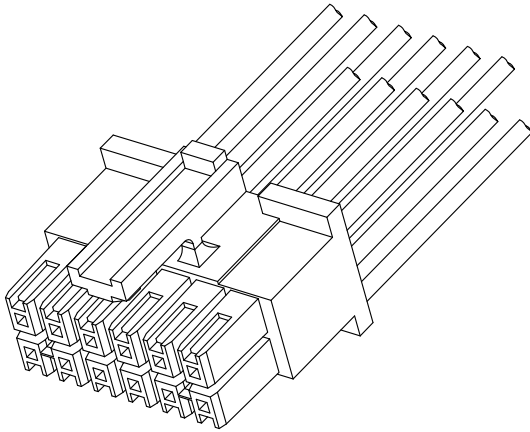

- Secure locking structure
- Low insertion force
- Suction area for picking up
- Improvement of engagement with prying

Specifications: _____

- Current rating: 3.0 A / AC,DC (AWG #22)
- Voltage rating: 250 V AC/DC
- Temperature range: -25°C ~ +105°C
(including temperature rise in applying electrical current)
- Contact resistance: Initial value/ 30mΩ max
Insulation resistance: 1000 MΩ min
Withstanding voltage: 1000 VAC/minute
Applicable wire: Conductor size/ AWG#24~#20
Insulation O.D./ 1.30 to 1.85 mm
- * Compliant with RoHS2/ REACH/ HF
- * Refer to "General Instruction and Notice when using Terminals and Connectors"
- * Contact CSG for details

Material: _____

Housing: PA66/UL94-V2;Color:White

Terminal: Phosphor/ Tin-plated/ Gold-Plated

- Note: 1. The above figure is the figure viewed from the connector mounting side.
2. Tolerances are non-cumulative: ±0.08 mm for all centers.
3. The dimensions above should serve as a guideline. Contact CSG for details.

CSG

Tel: +86-769-85312070 85375507 E-mail: James@csg-china.com www.csg-china.com www.jst-connector.cn

A2547 Samtec 2.54

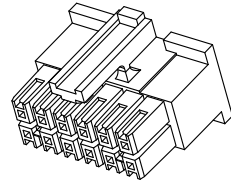
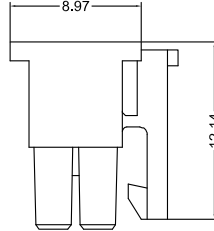
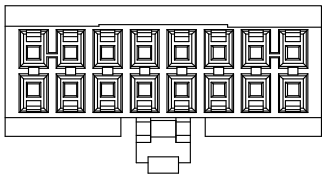
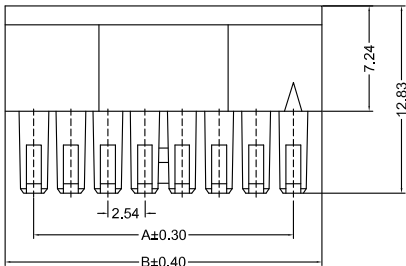
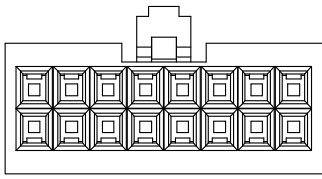

A2547HF 2XX XX P6 X 001
 PIN
 205=2X5PINS
 SPECIAL
 AK=BUCKLE
 Material
 P6=PA66 94V-0
 Code
 001
 Color
 9=White

CSG PART NO.	Dimension mm		Q'ty/BAG
	A	B	
A2547HF202AKP69001	2.54	8.26	1000PCS
A2547HF203AKP69001	5.08	10.80	1000PCS
A2547HF204AKP69001	7.62	13.34	1000PCS
A2547HF205AKP69001	10.16	15.88	1000PCS
A2547HF206AKP69001	12.70	18.42	1000PCS
A2547HF207AKP69001	15.24	20.96	1000PCS
A2547HF208AKP69001	17.78	23.50	1000PCS
A2547HF209AKP69001	20.32	26.04	1000PCS
A2547HF210AKP69001	22.86	28.58	1000PCS
A2547HF211AKP69001	25.40	31.12	1000PCS
A2547HF212AKP69001	27.94	33.66	1000PCS
A2547HF213AKP69001	30.48	36.20	1000PCS
A2547HF214AKP69001	33.02	38.74	1000PCS
A2547HF215AKP69001	35.56	41.28	1000PCS
A2547HF216AKP69001	38.10	43.82	1000PCS
A2547HF220AKP69001	48.26	43.98	1000PCS
A2547HF225AKP69001	60.96	66.68	1000PCS

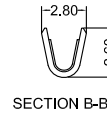
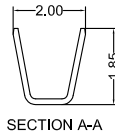
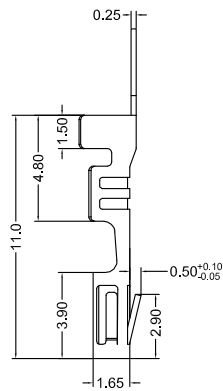
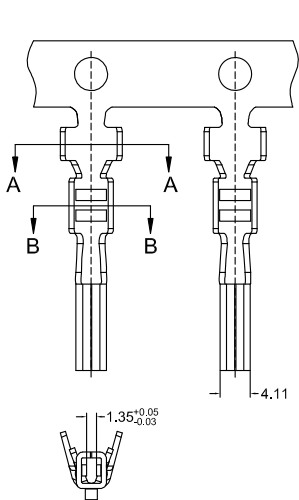

A2547 M 0 A XX 001
 Type
 M=Female Terminal
 SPECIAL
 O=NO Special
 Material
 A=Phosphor
 Finish
 TP=Tin-Plated
 GF=Gold-Plated G/F
 Code
 001

CSG PART NO.	Wire Range	Insulation O.D.	Q'ty/Reel
A2547M0ATP001	AWG#20-#24	1.85mm(max)	10000PCS
A2547M0AGF001	AWG#20-#24	1.85mm(max)	10000PCS

