

A1004 503764 CONNECTOR

1.00mm Pitch/Disconnectable Crimp style connectors

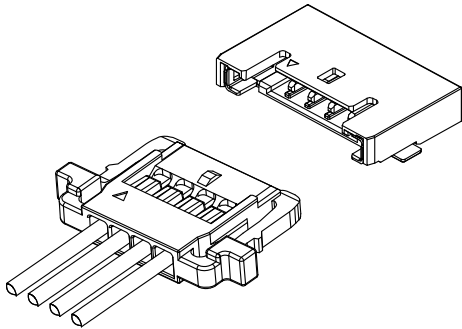

NOTE:

Current rating:1.5~2.5A AC,DC

Voltage rating:150V AC,DC

Temperature range:-25℃~+85℃

Insulation resistance:1000MΩ/Min

Withstanding voltage:500V AC/minute

Contact resistance:20mΩ/Max

Suitable With:A1004M Series Terminal



Specifications:

- Current rating: 1.5 A AC,DC (AWG #28)
- Voltage rating: 250 V AC/DC
- Temperature range: -25℃~+105℃
(including temperature rise in applying electrical current)
- Contact resistance: Initial value/ 20mΩ max
After environmental testing/ 40mΩ max
- Insulation resistance: 1000 MΩ min
- Withstanding voltage: 500 VAC/minute
- Applicable wire: Conductor size/ AWG#30 to #28
Insulation O.D./ 0.5 to 0.7 mm

* Compliant with RoHS2/ REACH

* In using the products, refer to "Handling Precautions for Terminals and Connectors "described on our website (Technical documents of Product information page).

* Contact CSG for details

Material:

Housing: PA66,UL94-V0;Color:Black

Terminal: Phosphor/ Tin-plated, Gold-Plated

Wafer Housing: 4T,UL94-V0;Color:Black

Wafer Pin: Phosphor/ Gold-Plated,TP= Tin-Plated

Wafer Fixed Foot: Bass/ Tin-plated

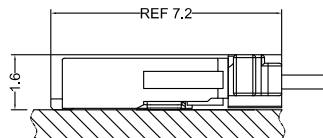

- Note: 1. The above figure is the figure viewed from the connector mounting side.
2. Tolerances are non-cumulative: ± 0.08 mm for all centers.
3. The dimensions above should serve as a guideline. Contact CSG for details.

CSG

Tel:+86-769-85312070 85375507 E-mail:James@csg-china.com www.csg-china.com www.jst-connector.cn

A1004 503764

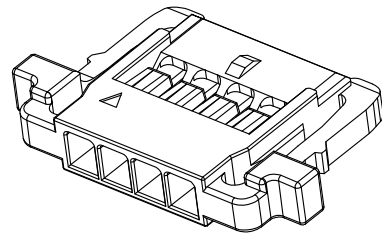
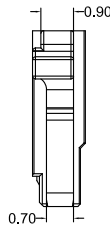
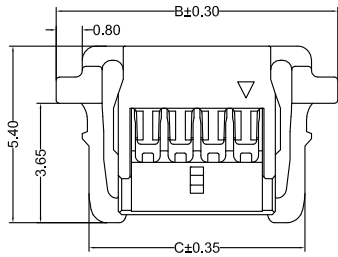
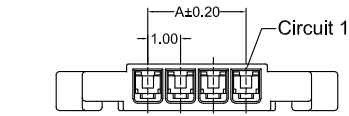

A1004HF 0XX AK P6 0 195
 PIN
 002=2PINS
 SPECIAL
 AK=BUCKLE
 Material
 P6=PA66 94V-0
 Code
 195
 Color
 0=Black

CSG PART NO.	Dimension mm			Q'ty/BAG
	A	B	C	
A1004HF002AKP60195	1.00	6.60	4.60	2000PCS
A1004HF003AKP60195	2.00	7.60	5.60	2000PCS
A1004HF004AKP60195	3.00	8.60	6.60	2000PCS
A1004HF005AKP60195	4.00	9.60	7.60	2000PCS
A1004HF006AKP60195	5.00	10.60	8.60	2000PCS

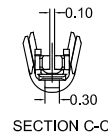
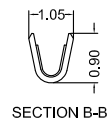
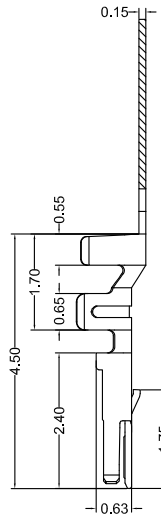
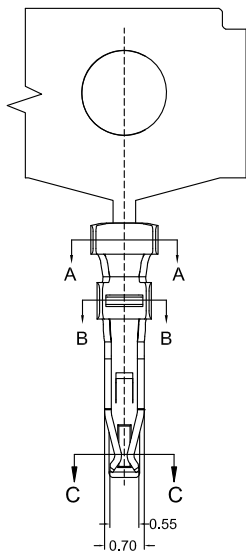

A1004 M 0 A XX 195
 Type
 M=Female Terminal
 Material
 A=Phosphor
 Finish
 GF=Gold-Plated
 TP=Tin-Plated
 Code
 195

CSG PART NO.	Wire Range	Insulation O.D.	Q'ty/Reel
A1004M0AGF195	AWG#28-#30	0.70mm(max)	20000PCS
A1004M0ATP195	AWG#28-#30	0.70mm(max)	20000PCS



A1004 503764

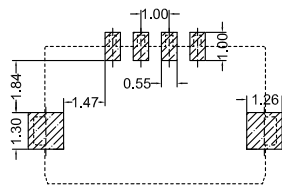
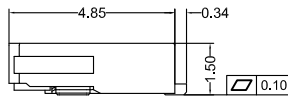
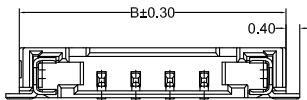
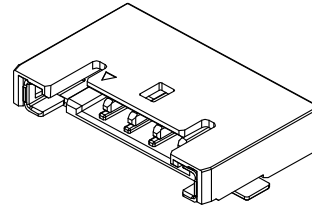
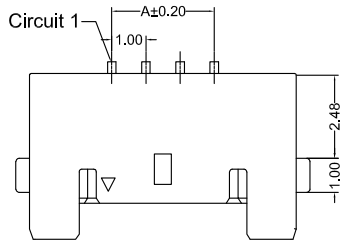

Recommended P.C.B Layout
General Tolerance±0.05

A1004RS_QXX AA 4T XX B 0 109

- PIN
- 002=2PINS
- SPECIAL
- AA=NO Special
- Material
- 4T=PA4T 94V-0
- Finish
- GF=Terminal Gold-Plated
- TP=Terminal Tin-Plated
- Code
- 109
- Color
- 0=Black
- Packing
- B=Tape & Reel

CSG PART NO.	Dimension mm		Q'ty/Reel
	A	B	
A1004RS002AA4TXXB0109	1.00	5.80	3000PCS
A1004RS003AA4TXXB0109	2.00	6.80	3000PCS
A1004RS004AA4TXXB0109	3.00	7.80	3000PCS
A1004RS005AA4TXXB0109	4.00	8.80	3000PCS
A1004RS006AA4TXXB0109	5.00	9.80	3000PCS

