

| REVISIONS | | | | |
|-----------|---------|-----------------|------------|----------|
| SYM | ECN No. | DESCRIPTION | DATE | APPROVED |
| A | | MASS-PRODUCTION | 10/27/2015 | James |

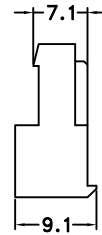

Bevel Type (AC)

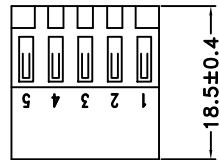
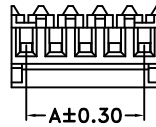
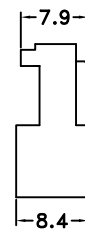
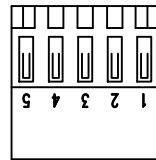

Right Angle Type (AD)

NOTE:
 Current rating:5A AC,DC
 Voltage rating:250V AC,DC
 Temperature range:-40°C~+85°C
 Insulation resistance:1000MΩ/Min
 Withstanding voltage:1500V AC/minute
 Contact resistance:20mΩ/Max

| CSG PART NO. | Dimension mm | |
|------------------------|--------------|-------|
| | A | B |
| A3962HI002XXXXP6XXX0XX | 3.96 | 7.92 |
| A3962HI003XXXXP6XXX0XX | 7.92 | 11.88 |
| A3962HI004XXXXP6XXX0XX | 11.88 | 15.84 |
| A3962HI005XXXXP6XXX0XX | 15.84 | 19.80 |
| A3962HI006XXXXP6XXX0XX | 19.80 | 23.76 |
| A3962HI007XXXXP6XXX0XX | 23.76 | 27.72 |
| A3962HI008XXXXP6XXX0XX | 27.72 | 31.68 |
| A3962HI009XXXXP6XXX0XX | 31.68 | 35.64 |
| A3962HI010XXXXP6XXX0XX | 35.64 | 39.60 |
| A3962HI011XXXXP6XXX0XX | 39.60 | 43.56 |
| A3962HI012XXXXP6XXX0XX | 43.56 | 47.52 |
| A3962HI013XXXXP6XXX0XX | 47.52 | 51.48 |
| A3962HI014XXXXP6XXX0XX | 51.48 | 55.44 |
| A3962HI015XXXXP6XXX0XX | 55.44 | 59.40 |
| A3962HI016XXXXP6XXX0XX | 59.40 | 63.36 |
| A3962HI017XXXXP6XXX0XX | 63.36 | 67.32 |
| A3962HI018XXXXP6XXX0XX | 67.32 | 71.28 |
| A3962HI019XXXXP6XXX0XX | 71.28 | 75.24 |
| A3962HI020XXXXP6XXX0XX | 75.24 | 79.20 |
| A3962HI021XXXXP6XXX0XX | 79.20 | 83.16 |
| A3962HI022XXXXP6XXX0XX | 83.16 | 87.12 |
| A3962HI023XXXXP6XXX0XX | 87.12 | 91.08 |
| A3962HI024XXXXP6XXX0XX | 91.08 | 95.04 |

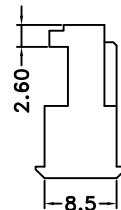
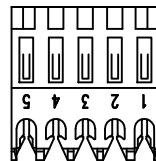
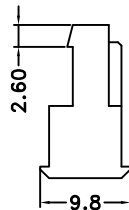
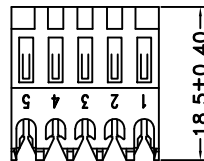
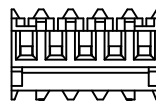
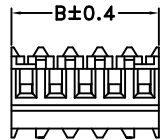

A3962HI OXX XX XX P6 XX X OXX

PIN
 002=2PIN
 003=3PIN

SPECIAL
 AC=Bevel
 AD=Right Angle

AWG#
 18=18 AWG
 20=20 AWG
 22=22 AWG
 24=24 AWG
 26=26 AWG

Code
 001=90°
 002=180°

Color
 9=White
 6=Blue
 4=Yellow
 3=Orange
 2=Red

Finish
 TP=Tin-Plated

Material
 P6=PA66 94-V2



| TOLERANCE UNIT(mm) | APPROVALS | DATE |
|----------------------------|-----------|------|
| X. ±0.30 | DRAWN | |
| X.X ±0.25 | CHECKED | |
| X.XX ±0.15 | APPROVED | |
| X.XXX ±0.10 | | |
| ANGULAR ±2° | | |
| UNLESS OTHERWISE SPECIFIED | | |

| | | | |
|----------------------------------|-----------------------------------|--|-----------|
| CSG Industrial Co.,Ltd | | | |
| TITLE 3.96 IDC Housing | | | |
| SCALE N.A. | PART NO. A3962HI0XXXXXP6XXX0XX | DRAWING NO. A3962HI0XXXXXP6XXX0XX A | REV. A |
| SHEET 1 OF 1 | CUSTOMER CODE | CUSTOMER PART NO. | |

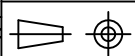

UNIT
MM